

39 Camira

*Windy*

Spirit of Scandinavia

recognized worldwide





*Windy*





Winnipeg



































39 Camira - Sun Lounge









## Windy 39 Camira

### Deck Fittings

Stainless deck cleats x 6  
 Pulpit and rails in stainless steel  
 Stainless anchor bow roller  
 Stainless Bruce anchor. 15 kg. 45 m. chain  
 Reversible anchor winch 1kW  
 Chain lockers - fender stowage  
 Starboard fresh water filler  
 Decksides discharge-point for holding tank  
 Flag holder  
 Signal horn  
 Double curved stainless steel framed safety glass windscreen  
 Access to foredeck through center of windscreen.  
 Navigation lights

### Cocpit

Self-bailing cockpit  
 Comfortable seating for 7/8  
 Seating adjustable to full sofa  
 Storage under seating  
 Handcrafted cockpit table in finest wood.  
 Full canopy in Helly Hansen® lightweight (light grey) material  
 Electrically operated canopy tightening system  
 Main switch and circuit breaker panel  
 FUSION 700 radio/docking station/USB port and Bluetooth  
 240V socket inside of Wet bar on portside  
 Hand-held fire extinguishers (2kg)

### Cocpit Galley

Indirect lights  
 Sink with hot & cold water  
 Gas cooker  
 Rubbish bin  
 Cockpit refrigerator

### Aft Sun Deck Area

Large sunbathing area.  
 Adjustable backrest for sun lounge configuration  
 Electrical struts on dinghy room hatch  
 Tender/dinghy garage under sun lounge.  
 Stainless steel rail  
 Shower on bathing platform

### Option:

Hydraulic bathing platform

### Helmsman's and Co-Pilots Positions

Helm position bridge with individual pilot and co-pilot  
 "Designer Chairs".  
 2 x windscreen wipers  
 Windscreen washer  
 Single electronic lever engine controls  
 Full analogue engine instrumentation  
 Switch panel for all service functions  
 Fresh water and fuel gauges  
 Compass  
 12V Socket  
 Glass holders  
 Fuel shut-off handles  
 FUSION 700 radio/docking station/USB port and Bluetooth  
 Nextel antiglare surface on dashboard  
 Demisting / Defroster system  
 Steering wheel Sport version

### Electrical Equipment

12 volt electrical system  
 4 x engine/domestic AGM batteries  
 Complete engine instrumentation  
 Fuel tank gauge  
 Water tank gauge  
 Hot water tank (40 litres) heated by engines / 240V  
 Holding tank w/ electric pump  
 Windscreen wipers  
 Windscreen washer  
 Horn  
 Bilge pumps, electrical and manual  
 Shower drain pump  
 Navigation lights  
 Switch panel and circuit breakers

### Below Deck and Service Galley

Oak floor  
 Overhead cupboard with Micro-oven  
 Drawers for crockery and cutlery  
 Overhead LED strip lights  
 Indirect lights companionway  
 Indirect lights lower pantry.  
 Dimmer  
 Galley top in high-grade composite material  
 Sink with hot & cold water  
 Large electric refrigerator 85 l  
 Drawers for storage  
 Double 240V AC socket

### Forward Stateroom

Double berth with high-quality spring mattress  
 Drawer under double berth  
 Skillfully crafted woodwork  
 Full hanging wardrobe  
 Lights in wardrobe  
 Overhead lockers  
 Cupboard with makeup table and drawers with mirror  
 Oak floor  
 Reading lights (2)  
 Overhead LED strip lights  
 240V / 12V socket  
 Blinds  
 Indirect LED lights  
 Dimmer  
 Skylight hatch with mosquito net and night screen

### Center Guest Cabin

Double berth with high-quality spring mattresses  
 Skillfully crafted interior woodwork  
 Full hanging wardrobe  
 Lights in wardrobe  
 Overhead locker  
 Oak floor  
 Reading lights (2)  
 Overhead LED strip lights  
 Hull window ventilation opening with mosquito net.  
 Blind  
 Indirect LED lights  
 Dimmer

### Shower and Heads

Counter top in high-grade composite material  
 Wash basin with hot and cold water taps and accessories  
 Electric toilet.  
 Separate shower compartment.  
 Esthetic grating on shower floor  
 Glass holder  
 Towel hangers  
 Skillfully crafted interior woodwork  
 Overhead locker  
 Bathroom cupboard with mirror  
 Overhead LED strip lights  
 Blind  
 Extractor fan  
 AC socket for shaver or dryer (240V)  
 Indirect LED light in niche  
 Dimmer

## Windy 39 Camira - Sun Lounge

### Overall dimentions

Length 12,28 meters  
 Beam 3,67 meters  
 Height 3,00 meters  
 Height including cradle 3,15 meters  
 Weight incl. engine 7 500 kg  
 Fuel tank 810 liters  
 Fresh water 200 liters (+ 40 liters hot water)  
 Berths 4-5 pers

Exterior design and styling: Dubois Nav. Arch. Ltd. UK

Interior design: Design Unlimited Ltd, UK

Naval Architect: Hans Jørgen Johnsen, Norway

## Windy 39 Camira - Sport

### Overall dimentions

Length 11,98 meters  
 Beam 3,67 meters  
 Height 3,00 meters  
 Height including cradle 3,15 meters  
 Weight incl. engine 7 500 kg  
 Fuel tank 810 liters  
 Fresh water 200 liters (+ 40 liters hot water)  
 Berths 4-5 pers

Exterior design and styling: Dubois Nav. Arch. Ltd. UK

Interior design: Design Unlimited Ltd, UK

Naval Architect: Hans Jørgen Johnsen, Norway

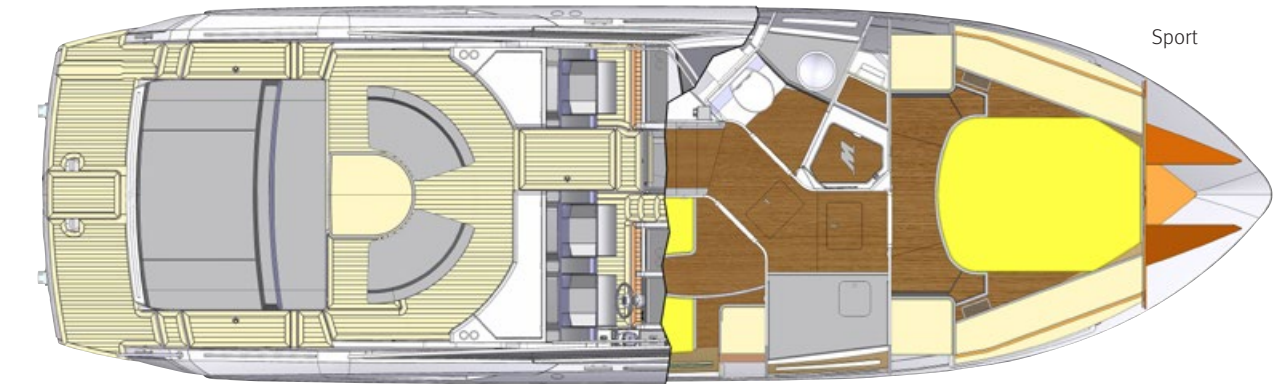

Sport

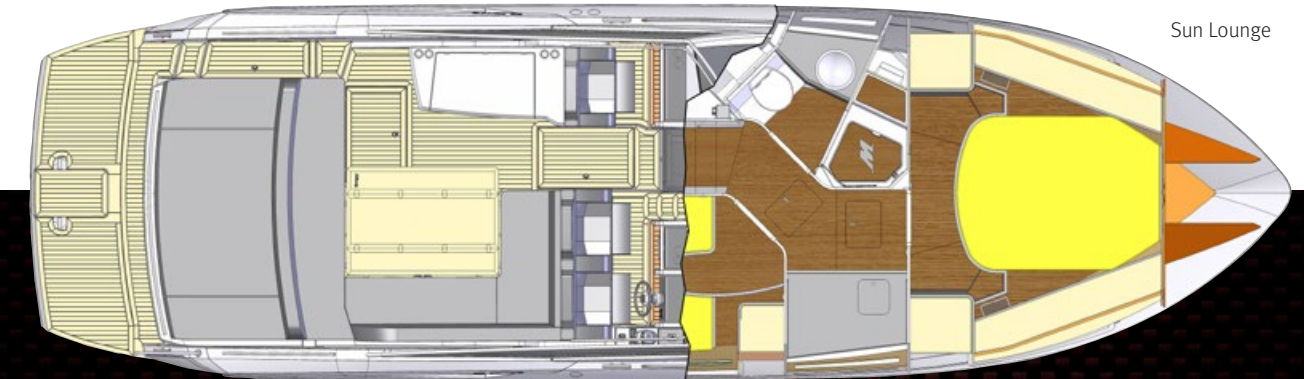

Sun Lounge

# Specifications

Windy Boats undergoes a continuous process of renewal, development and amendments to standard specifications of its products. Specifications presented in this document may be changed without prior notice.





Windy Boats pursues a policy of continuous product innovation and enhancement. Everything presented in this brochure is subject to change without prior notice. This brochure must therefore be taken only as non-binding guidelines from Windy Boats • The images shown in this brochure do not necessarily show standard boats and cannot therefore be used as references for the standard specification for each individual model • All boats manufactured by Windy Boats are approved for specific categories by RINA and are CE-labelled • Every attempt is made to ensure that all information in this brochure is as accurate as possible, but it is important to note that a boat's performance and test data are given only as guidance • Fouling of the hull and stern gear, by for example marine growth and mud, propeller damage, engine set-up, engine manufacture and type, air and water temperatures, the weight of fuel, water, stowage and the number of persons on board may all affect the boats' performance and test data. For these and other reasons, Windy Boats is unable to provide any guarantee of test data and boat performance • This brochure was produced by Innoventi AS, Arendal, autumn 2014 • Windy Boats reserves all rights in this brochure. Reproduction prohibited without written authorisation by the copyright holder • Windy Oceancraft, Draco Oceancraft, Draco and WinTec are trademarks of Windy Boats.





WINDY BOATS A.S. · SKARPNES, BOX 40, N-4854 NEDENES, NORWAY · TEL: +47 37 05 85 55

[WWW.WINDYBOATS.COM](http://WWW.WINDYBOATS.COM) · [SALES@WINDY.NO](mailto:SALES@WINDY.NO)

WINDY SCANDINAVIA AB · SÖDRA VARVSGT. 27 · SE-593 50 VÄSTERVIK · SWEDEN · TEL.: +46 490 258 850

[INFO@WINDYSCANDINAVIA.SE](mailto:INFO@WINDYSCANDINAVIA.SE)